



## MOULD COOLING PRODUCTS

The temperature control of molds in injection presses is a crucial point when you manufacture plastics and especially new high-tech plastics.

Therefore, it is very important to equip the hot and cold water circuits with suitable water connections.

ZonaCentro has a varied line of mold couplings at your disposal.

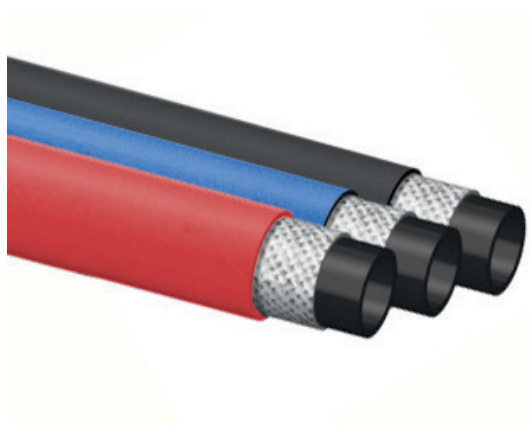

**TYPE MLH**
**PUSH-LOCK HOSES**
**PUSH-LOCK HOSES**

**DESCRIPTION**

- Easy Assembly
- No Clamp Needed
- Used in cooling circuits
- Available in 3 colors

**WORKING TEMPERATURE RANGES**

WATER	- 20°C	+ 90°C
AIR	- 20°C	+ 90°C

REFERENCES			Ø INSIDE	Ø OUTSIDE	MAX. WORKING PRESSURE		BURSTING PRESSURE	
RED	BLUE	BLACK			BAR	PSI	BAR	PSI
ML10R	ML10B	ML10BK	10	16	20	300	82	1200
ML13R	ML13B	ML13BK	12	19	20	300	82	1200
ML16R	ML16B	ML16BK	16	23	20	300	82	1200

**TYPE HC**
**HOSE CLAMPS**
**HOSE CLAMP**

REFERENCE	HOSE SIZE
A01417	14 - 17
A01821	18 - 21
A02023	20 - 23
A02327	23 - 27
A02528	25 - 28



REFERENCE	HOSE SIZE
ASF816	8 - 16
ASF1222	12 - 22
ASF1627	16 - 27
ASF2032	20 - 32
ASF2540	25 - 40



## TYPE DM

## MANIFOLD DISTRIBUTOR

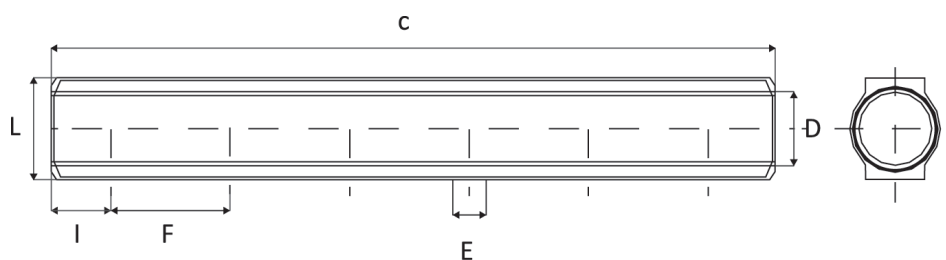

REFERENCE	C	D x E	F	I	L
DM1x38E2	80	1 x 3/8	35	23	41
DM1x38E3	115	1 x 3/8	35	23	41
DM1x38E4	150	1 x 3/8	35	23	41
DM1x38E5	185	1 x 3/8	35	23	41
DM1x38E6	220	1 x 3/8	35	23	41
DM1x38E7	225	1 x 3/8	35	23	41
DM1x38E8	290	1 x 3/8	35	23	41
DM1x38E9	325	1 x 3/8	35	23	41
DM1x38E10	360	1 x 3/8	35	23	41
DM1x38E11	395	1 x 3/8	35	23	41
DM1x38E12	430	1 x 3/8	35	23	41

REFERENCE	C	D x E	F	I	L
DM1x12E2	99	1 x 1/2	50	25	42
DM1x12E3	149	1 x 1/2	50	25	42
DM1x12E4	199	1 x 1/2	50	25	42
DM1x12E5	249	1 x 1/2	50	25	42
DM1x12E6	299	1 x 1/2	50	25	42
DM1x12E7	349	1 x 1/2	50	25	42
DM1x12E8	399	1 x 1/2	50	25	42
DM1x12E9	449	1 x 1/2	50	25	42
DM1x12E10	499	1 x 1/2	50	25	42
DM1x12E11	549	1 x 1/2	50	25	42
DM1x12E12	599	1 x 1/2	50	25	42

REFERENCE	C	D x E	F	I	L
DM114x12E2	99	114 x 1/2	50	25	51
DM114x12E3	149	114 x 1/2	50	25	51
DM114x12E4	199	114 x 1/2	50	25	51
DM114x12E5	249	114 x 1/2	50	25	51
DM114x12E6	299	114 x 1/2	50	25	51
DM114x12E7	349	114 x 1/2	50	25	51
DM114x12E8	399	114 x 1/2	50	25	51
DM114x12E9	449	114 x 1/2	50	25	51
DM114x12E10	499	114 x 1/2	50	25	51
DM114x12E11	549	114 x 1/2	50	25	51
DM114x12E12	599	114 x 1/2	50	25	51



**TYPE BDM**

**MANIFOLD DISTRIBUTOR**

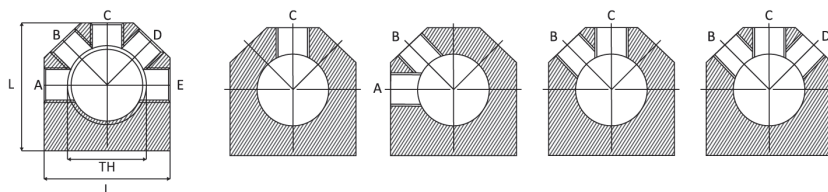
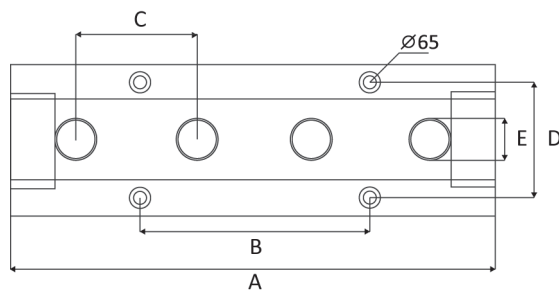
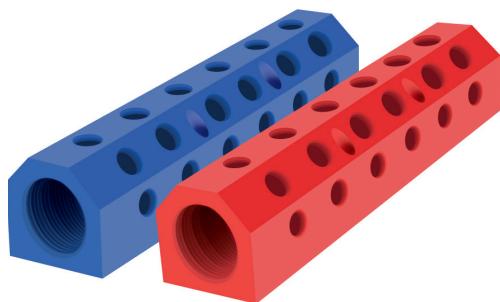

TH	A	B	C	D	E		L
1" BSP	103	0	40	38	BSP 1/4	BSP 3/8	60
	183	80	40	38	BSP 1/4	BSP 3/8	60
	263	160	40	38	BSP 1/4	BSP 3/8	60
	343	240	40	38	BSP 1/4	BSP 3/8	60

**EXAMPLE CODE** **BDM 1 E38 ACE 4 B**

Type BDM

INTEL ( 1"BSP)

Outlet Thread Size  
( 1/4 / 14 or 3/8 / 38)

Position of holes in the manifold

Number of holes in the surface

Color ( R / Red or B / Blue)

**TYPE TD**

**PRESSURE PLUG**



REFERENCE	TH
TDM1	BSP 1
TDM114	BSP 11/4



## TYPE MF

## FLEXIBLE HOSE ADAPTER MALE

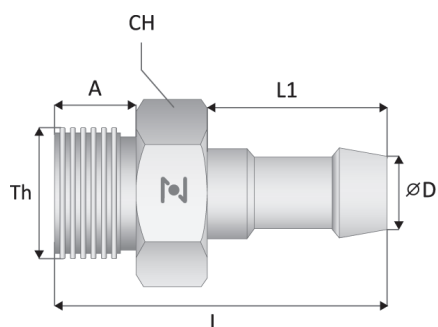

REFERENCE	Ø D		TH	A	CH	L	L1
M10N18	10	3/8	BSP 1/8	8	14	43	28
M10N14	10	3/8	BSP 1/4	10	16	42	22
M13N14	13	1/2	BSP 1/4	11	17	46	37
M10N38	10	3/8	BSP 3/8	12	19	47	28
M13N38	13	1/2	BSP 3/8	12	19	52	32
M16N38	16	5/8	BSP 3/8	12	19	52	33
M13N12	13	1/2	BSP 1/2	14	22	54	33
M16N12	16	5/8	BSP 1/2	14	22	54	33
M16N34	16	5/8	BSP 3/4	16	30	58	33

! NEED CLAMP

## TYPE ML

## PUSH-LOCK HOSE ADAPTER MALE

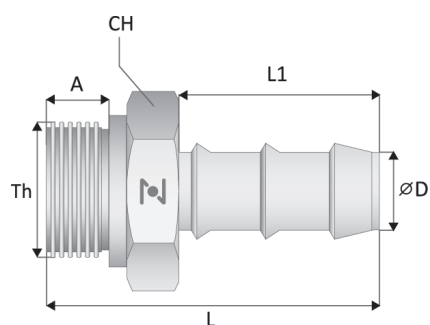

REFERENCE	Ø D		TH	A	CH	L	L1
ML10N18	10	3/8	BSP 1/8	9	19	41	25
ML13N14	13	1/2	BSP 1/4	9	19	49	29
ML10N38	10	3/8	BSP 3/8	9	22	42	25
ML13N38	13	1/2	BSP 3/8	10	22	49	29
ML16N38	16	5/8	BSP 3/8	10	22	57	37
ML13N12	13	1/2	BSP 1/2	11	27	50	29
ML16N12	16	5/8	BSP 1/2	11	27	57	37

! NO CLAMP NEEDED  
WITH O'RINGS



**TYPE S0**



**FULL FLOW**

**PUSH-LOCK HOSE MALE THREAD PLUG**

**PLUG**

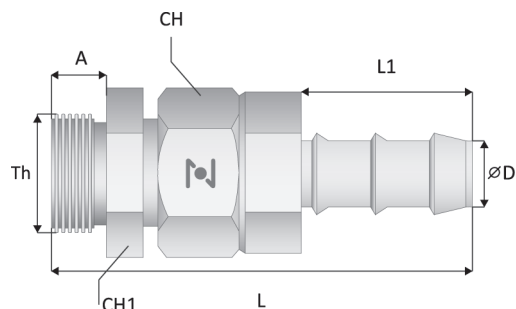

**! NO CLAMP NEEDED**

REFERENCE	TH	ØD	A	L	L1	CH	CH1
OA10R14	BSP 1/4	10	9	63	25	22	22
OA10R38	BSP 3/8	10	9	63	25	22	22
OA10R12	BSP 1/2	10	9	63	25	22	22
OA10R34	BSP 3/4	10	9	63	25	22	27
OA13R14	BSP 1/4	13	9	63	25	22	22
OA13R38	BSP 3/8	13	9	66	29	22	22
OA13R12	BSP 1/2	13	9	66	29	22	22
OA13R34	BSP 3/4	13	9	66	29	22	27
OA16R14	BSP 1/4	16	9	63	36	22	22
OA16R38	BSP 3/8	16	9	75	36	22	22
OA16R12	BSP 1/2	16	9	75	36	22	22
OA16R34	BSP 3/4	16	9	75	36	22	27

**TYPE S0**



**FULL FLOW**

**PUSH-LOCK HOSE MALE THREAD PLUG 45°**

**PLUG 45°**

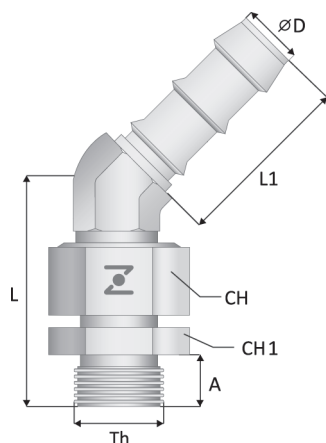

**! NO CLAMP NEEDED**

REFERENCE	TH	ØD	A	L	L1	CH	CH1
OAB10R14	BSP 1/4	10	9	47	25	22	22
OAB10R38	BSP 3/8	10	9	47	25	22	22
OAB10R12	BSP 1/2	10	9	47	25	22	22
OAB10R34	BSP 3/4	10	9	47	25	22	27
OAB13R14	BSP 1/4	13	9	47	25	22	22
OAB13R38	BSP 3/8	13	9	47	29	22	22
OAB13R12	BSP 1/2	13	9	47	29	22	22
OAB13R34	BSP 3/4	13	9	47	29	22	27
OAB16R14	BSP 1/4	16	9	47	36	22	22
OAB16R38	BSP 3/8	16	9	47	36	22	22
OAB16R12	BSP 1/2	16	9	47	36	22	22
OAB16R34	BSP 3/4	16	9	47	36	22	27

**TYPE S0**



**FULL FLOW**

**PUSH-LOCK HOSE MALE THREAD PLUG 90°**

**PLUG 90°**

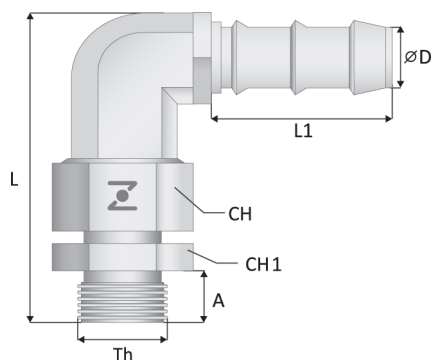

**! NO CLAMP NEEDED**

REFERENCE	TH	ØD	A	L	L1	CH	CH1
OAC10R14	BSP 1/4	10	9	54	25	22	22
OAC10R38	BSP 3/8	10	9	54	25	22	22
OAC10R12	BSP 1/2	10	9	54	25	22	22
OAC10R34	BSP 3/4	10	9	54	25	22	27
OAC13R14	BSP 1/4	13	9	54	25	22	22
OAC13R38	BSP 3/8	13	9	54	29	22	22
OAC13R12	BSP 1/2	13	9	54	29	22	22
OAC13R34	BSP 3/4	13	9	54	29	22	27
OAC16R14	BSP 1/4	16	9	54	36	22	22
OAC16R38	BSP 3/8	16	9	54	36	22	22
OAC16R12	BSP 1/2	16	9	54	36	22	22
OAC16R34	BSP 3/4	16	9	54	36	22	27



**TYPE S0**

FULL FLOW

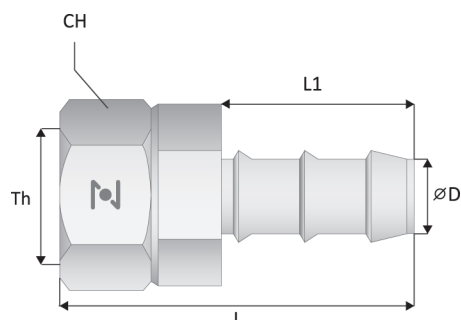
**PUSH-LOCK HOSE FEMALE THREAD PLUG****PLUG**

REFERENCE	TH	ØD	L	L1	CH
OA10F38	BSP 3/8	10	46,5	25	22
OA10F34	BSP 3/4	10	50	25	27
OA13F38	BSP 3/8	13	49,5	29	22
OA13F34	BSP 3/4	13	53	29	27
OA16F38	BSP 3/8	16	58,5	36	22
OA16F34	BSP 3/4	16	62	36	27

**NO CLAMP NEEDED****TYPE S0**

FULL FLOW

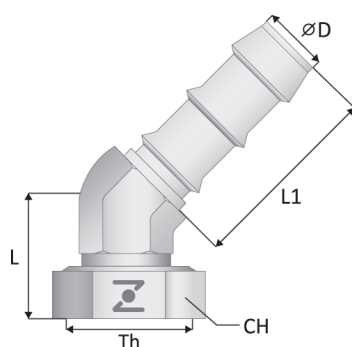
**PUSH-LOCK HOSE FEMALE THREAD PLUG 45°****PLUG 45°**

REFERENCE	TH	ØD	L	L1	CH
OAB10F38	BSP 3/8	10	28	25	22
OAB10F34	BSP 3/4	10	32	25	30
OAB13F38	BSP 3/8	13	28	29	22
OAB13F34	BSP 3/4	13	32	29	30
OAB16F38	BSP 3/8	16	28	36	22
OAB16F34	BSP 3/4	16	32	36	30

**NO CLAMP NEEDED****TYPE S0**

FULL FLOW

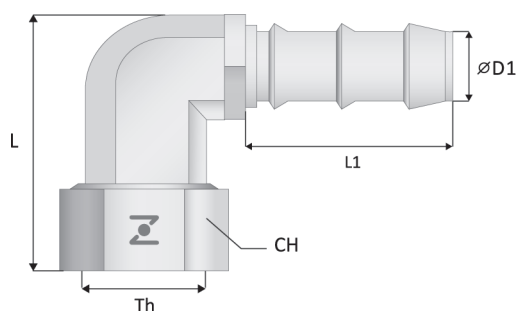
**PUSH-LOCK HOSE FEMALE THREAD PLUG 90°****PLUG 90°**

REFERENCE	TH	ØD	L	L1	CH
OAC10F38	BSP 3/8	10	37	25	22
OAC10F34	BSP 3/4	10	41	25	27
OAC13F38	BSP 3/8	13	37	29	22
OAC13F34	BSP 3/4	13	41	29	27
OAC16F38	BSP 3/8	16	37	36	22
OAC16F34	BSP 3/4	16	41	36	27

**NO CLAMP NEEDED**



**TYPE S0**

**FULL FLOW**

**FEMALE THREAD PLUG 45°**

**PLUG 45°**

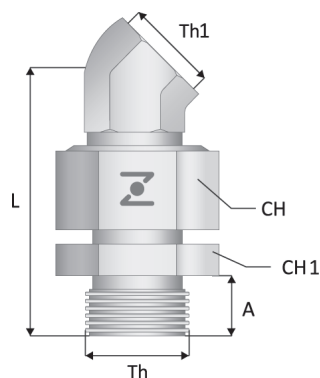

REFERENCE	TH	TH1	A	L	CH	CH1
OABF14R14	BSP 1/4	BSP 1/4	9	47	22	22
OABF14R38	BSP 1/4	BSP 3/8	9	47	22	22
OABF38R14	BSP 3/8	BSP 1/4	9	47	22	22
OABF38R38	BSP 3/8	BSP 3/8	9	47	22	22
OABF12R14	BSP 1/2	BSP 1/4	9	47	22	22
OABF12R38	BSP 1/2	BSP 3/8	9	47	22	22
OABF34R14	BSP 3/4	BSP 1/4	9	47	22	27
OABF34R38	BSP 3/4	BSP 3/8	9	47	22	27

**TYPE S0**

**FULL FLOW**

**FEMALE THREAD PLUG 90°**

**PLUG 90°**

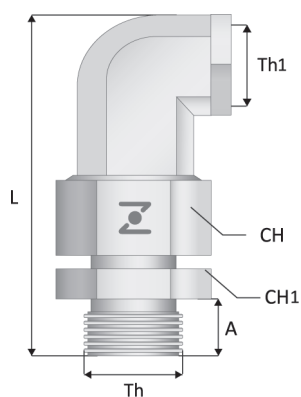

REFERENCE	TH	TH1	A	L	L1	CH	CH1
OACF14R14	BSP 1/4	BSP 1/4	9	54	25	22	22
OACF14R38	BSP 1/4	BSP 3/8	9	54	25	22	22
OACF38R14	BSP 3/8	BSP 1/4	9	54	25	22	22
OACF38R38	BSP 3/8	BSP 3/8	9	54	25	22	22
OACF12R14	BSP 1/2	BSP 1/4	9	54	25	22	22
OACF12R38	BSP 1/2	BSP 3/8	9	54	25	22	22
OACF34R14	BSP 3/4	BSP 1/4	9	54	25	22	27
OACF34R38	BSP 3/4	BSP 3/8	9	54	25	22	27



**TYPE JMF**
**ELBOW MALE/FEMALE**
**ELBOW**

REFERENCE	THREAD
JMF1890	BSP 1/8
JMF1490	BSP 1/4
JMF3890	BSP 3/8
JMF1290	BSP 1/2
JMF3490	BSP 3/4
JMF190	BSP 1
JMF11490	BSP 1 1/4
JMF11290	BSP 1 1/2

**TYPE JF**
**ELBOW FEMALE**
**ELBOW**

REFERENCE	THREAD
JFF1890	BSP 1/8
JFF1490	BSP 1/4
JFF3890	BSP 3/8
JFF1290	BSP 1/2
JFF3490	BSP 3/4
JFF190	BSP 1
JFF11490	BSP 1 1/4
JFF11290	BSP 1 1/2

**TYPE CS**
**COLLECTOR SUPPORT**

**REFERENCE**

CSDM

**TYPE MNB**
**NIPPLE MALE**

BRASS	STEEL	THREAD
MNB18	MNS18	BSP 1/8
MNB14	MNS14	BSP 1/4
MNB38	MNS38	BSP 3/8
MNB12	MNS12	BSP 1/2
MNB34	MNS34	BSP 3/4
MNB100	MNS100	BSP 1
MNB114	MNS114	BSP 1 1/4
MNB112	MNS112	BSP 1 1/2
MNB200	MNS200	BSP 2



## TYPE MR

## REDUCER MALE



BRASS	STEEL	THREAD
MRB1814	MRS1814	BSP 1/8 x 1/4
MRB1838	MRS1838	BSP 1/8 x 3/8
MRB1438	MRS1438	BSP 1/4 x 3/8
MRB1412	MRS1412	BSP 1/4 x 1/2
MRB3812	MRS3812	BSP 3/8 x 1/2
MRB3834	MRS3834	BSP 3/8 x 3/4
MRB1234	MRS1234	BSP 1/2 x 3/4
MRB341	MRS341	BSP 3/4 x 1
MRB1114	MRS1114	BSP 1 x 1 1/4
MRB114200	MRS114200	BSP 1 1/4 x 2

## TYPE RMF

## REDUCER MALE / FEMALE



BRASS M/M	BRASS NIQUEL	THREAD	
		MALE	FEMALE
RM14F18	RM14F18N	BSP 1/4	BSP 1/8
RM38F18	RM38F18N	BSP 3/8	BSP 1/8
RM38F14	RM38F14N	BSP 3/8	BSP 1/4
RM12F18	RM12F18N	BSP 1/2	BSP 1/8
RM12F14	RM12F14N	BSP 1/2	BSP 1/4
RM12F38	RM12F38N	BSP 1/2	BSP 3/8
RM34F38	RM34F38N	BSP 3/4	BSP 3/8
RM34F12	RM34F12N	BSP 3/4	BSP 1/2
RM1F38	RM1F38N	BSP 1	BSP 3/8
RM1F12	RM1F12N	BSP 1	BSP 1/2
RM1F34	RM1F34N	BSP 1	BSP 3/4

## TYPE UMF

## UNION MALE / FEMALE



BRASS	THREAD
UMF1818	BSP 1/8 x 1/8
UMF1814	BSP 1/8 x 1/4
UMF1838	BSP 1/8 x 3/8
UMF1414	BSP 1/4 x 1/4
UMF1438	BSP 1/4 x 3/8
UMF1412	BSP 1/4 x 1/2
UMF3838	BSP 3/8 x 3/8
UMF3812	BSP 3/8 x 1/2
UMF1212	BSP 1/2 x 1/2
UMF1234	BSP 1/2 x 3/4



**TYPE SG**

→ FULL FLOW

**QUICK COUPLINGS**

**SOCKET**

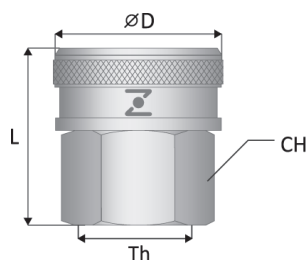

REFERENCE	TH (G)	Ø D	CH	L
SG25FF1	BSP 1	57	46	57
SG33FF114	BSP 1 1/4	65	54	62

**TYPE PG**

→ FULL FLOW

**QUICK COUPLINGS**

**PLUG**

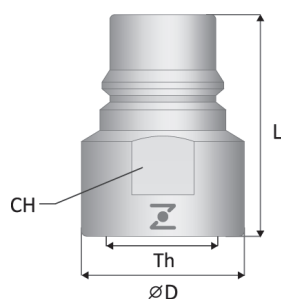

REFERENCE	TH (G)	Ø D	CH	L
PG25FM1	BSP 1	45	41	61
PG33FM114	BSP 1 1/4	55	50	66

**TYPE SM**

→ FULL FLOW

**SNAPLOCK COUPLINGS**

**MALE TYPE A PLUG**



REFERENCE			TH(G)
ALUMINIUM	STAINLESS STEEL	BRONZE	
SAM1	SIM1	SBM1	BSP 1
SAM114	SIM114	SBM114	BSP 1 1/4

**TYPE SF**

→ FULL FLOW

**SNAPLOCK COUPLINGS**

**FEMALE TYPE B SOCKET**



REFERENCE			TH(G)
ALUMINIUM	STAINLESS STEEL	BRONZE	
SAF1	SIF1	SBF1	BSP 1
SAF114	SIF114	SBF114	BSP 1 1/4



## TYPE WT

## MINI BALL VALVE MALE / FEMALE

## BALL VALVE

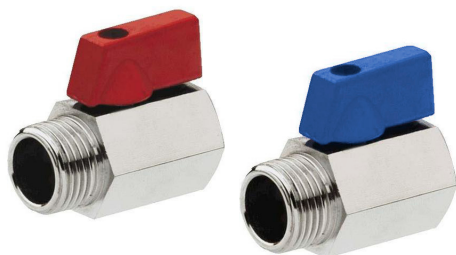

REFERENCE		TH (MALE/FEMALE)
RED	BLUE	
WT18MFR	WT18MFB	BSP 1/8
WT14MFR	WT14MFB	BSP 1/4
WT38MFR	WT38MFB	BSP 3/8
WT12MFR	WT12MFB	BSP 1/2
WT34MFR	WT34MFB	BSP 3/4

## TYPE WT

## MINI BALL VALVE FEMALE

## BALL VALVE

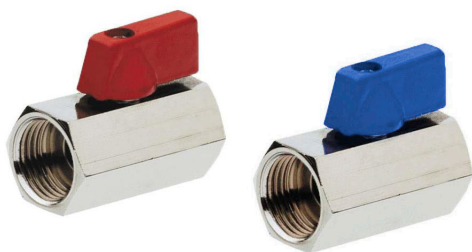

REFERENCE		TH (MALE/FEMALE)
RED	BLUE	
WT18FFR	WT18FFB	BSP 1/8
WT14FFR	WT14FFB	BSP 1/4
WT38FFR	WT38FFB	BSP 3/8
WT12FFR	WT12FFB	BSP 1/2
WT34FFR	WT34FFB	BSP 3/4

## TYPE VBH

## SHORT HANDLE BALL VALVE FEMALE

## BALL VALVE

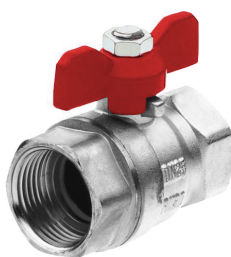

REFERENCE	TH (MALE/FEMALE)
VBH14F	BSP 1/4
VBH38F	BSP 3/8
VBH12F	BSP 1/2
VBH34F	BSP 3/4
VBH1F	BSP 1

## TYPE VBH

## SHORT HANDLE BALL VALVE MALE/FEMALE

## BALL VALVE

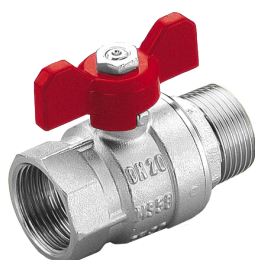

REFERENCE	TH (MALE/FEMALE)
VBH14MF	BSP 1/4
VBH38MF	BSP 3/8
VBH12MF	BSP 1/2
VBH34MF	BSP 3/4
VBH1MF	BSP 1



**TYPE VLH**

**LARGE HANDLE BALL VALVE FEMALE**

**BALL VALVE**



REFERENCE	TH (MALE/FEMALE)
VLH14F	BSP 1/4
VLH38F	BSP 3/8
VLH12F	BSP 1/2
VLH34F	BSP 3/4
VLH1F	BSP 1
VLH114F	BSP 1 1/4
VLH112F	BSP 1 1/2
VLH2F	BSP 2

**TYPE VLH**

**SHORT HANDLE BALL VALVE MALE/FEMALE**

**BALL VALVE**



REFERENCE	TH (MALE/FEMALE)
VLH14MF	BSP 1/4
VLH38MF	BSP 3/8
VLH12MF	BSP 1/2
VLH34MF	BSP 3/4
VLH1MF	BSP 1
VLH114MF	BSP 1 1/4
VLH112MF	BSP 1 1/2
VLH2MF	BSP 2

**TYPE BV**

**BALL VALVE WITH 2 PIECES CONNECTOR**

**BALL VALVE**



REFERENCE	TH (MALE/FEMALE)
BV2PS12MF	BSP 1/2
BV2PS34MF	BSP 3/4
BV2PS1MF	BSP 1
BV2PS114MF	BSP 1 1/4

**TYPE BV**

**BALL VALVE WITH THERMOMETER**

**BALL VALVE**



REFERENCE	TH (MALE/FEMALE)
BVTH1MF	BSP 1



TYPE FR

FLOW METER

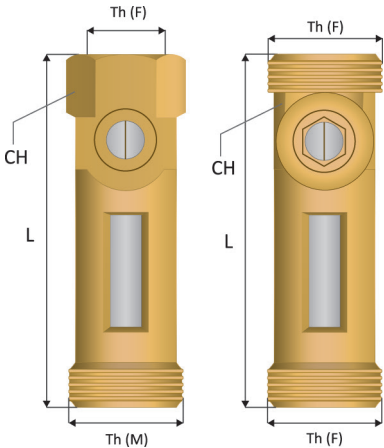

- Operating temperature: 100° C Max.
- Operating pressure: 10 Bar

REFERENCE	TH	CH	L	FLOW	Kvs (m³/h)
FR12F34M	1/2 BSP (F) - 3/4 BSP (M)	24	81	2,0 - 8,0 (l/min)	1,8
FR1M1M	1 BSP (M/M)	30	104	4,0 - 15 (l/min)	5,0

TYPE OFR

ORIENTED FLOW METER MALE/FEMALE

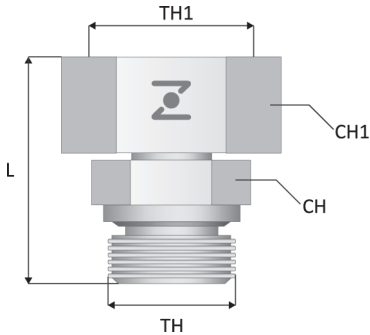

REFERENCE	TH	TH1	CH	CH1	L
OFR38M34F	BSP 3/8	BSP 3/4	22	30	38
OFR12M34F	BSP 1/2	BSP 3/4	22	30	38

TYPE OFR

ORIENTED FLOW METER MALE

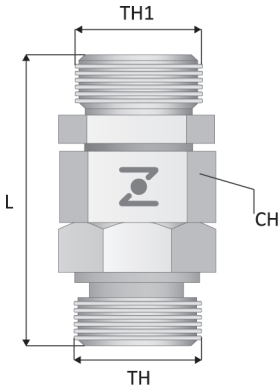

REFERENCE	TH	TH1	CH	L
OFR38M	BSP 3/8	BSP 3/8	22	52
OFR3812M	BSP 3/8	BSP 1/2	22	52
OFR12M	BSP 1/2	BSP 1/2	22	52



**TYPE VD**

**SEALING O-RING**



**EXAMPLE CODE**

**VD 10,00 x 2,50 NBR**

Type VD

Ø Inside

Ø Thickness

Material

**TEMPERATURE RANGE**

MATERIAL	NBR	-25°C AND 100°C
	FPM (VITON)	-20°C AND 220°C
	EPDM	-45°C AND 130°C

**TYPE SC**

**STEEL JOINT WITH NITRILE RING**



REFERENCE	THREAD
SC18	BSP 1/8
SC14	BSP 1/4
SC38	BSP 3/8
SC12	BSP 1/2
SC34	BSP 3/4
SC1	BSP 1

**TYPE ZC**

**CYCLE COUNTER**

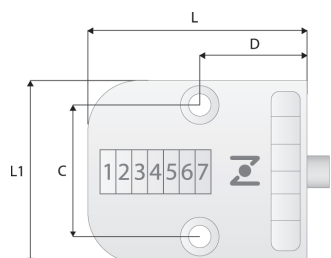

REFERENCE	L	L1	C	D
ZCC	47,5	38	28	24



## TYPE MS

## MALE THREAD FITTING WITH PUSH IN

## STRAIGHT



REFERENCE	HOSE	TH (MALE)
TP8R18	8	BSP 1/8
TP8R14	8	BSP 1/4
TP8R38	8	BSP 3/8
TP8R12	8	BSP 1/2
TP10R18	10	BSP 1/8
TP10R14	10	BSP 1/4
TP10R38	10	BSP 3/8
TP10R12	10	BSP 1/2
TP12R18	12	BSP 1/8
TP12R14	12	BSP 1/4
TP12R38	12	BSP 3/8
TP12R12	12	BSP 1/2

## TYPE ME

## MALE ELBOW THREAD FITTING WITH PUSH IN

## ELBOW



REFERENCE	HOSE	TH (MALE)
TP8R18C	8	BSP 1/8
TP8R14C	8	BSP 1/4
TP8R38C	8	BSP 3/8
TP8R12C	8	BSP 1/2
TP10R18C	10	BSP 1/8
TP10R14C	10	BSP 1/4
TP10R38C	10	BSP 3/8
TP10R12C	10	BSP 1/2
TP12R18C	12	BSP 1/8
TP12R14C	12	BSP 1/4
TP12R38C	12	BSP 3/8
TP12R12C	12	BSP 1/2

## TYPE MS

## MALE STRAIGHT CONNECTOR

## STRAIGHT



REFERENCE	THREAD	
MS186	BSP 1/8	6 x 4 mm
MS146	BSP 1/4	6 x 4 mm
MS386	BSP 3/8	6 x 4mm
MS126	BSP 1/2	6 x 4 mm
MS188	BSP 1/8	8 x 6 mm
MS148	BSP 1/4	8 x 6 mm
MS388	BSP 3/8	8 x 6 mm
MS128	BSP 1/2	8 x 6 mm
MS1810	BSP 1/8	10 x 8 mm
MS1410	BSP 1/4	10 x 8 mm
MS3810	BSP 3/8	10 x 8 mm
MS1210	BSP 1/2	10 x 8 mm



**TYPE ME**

**SWIVEL MALE ELBOW**

**ELBOW**

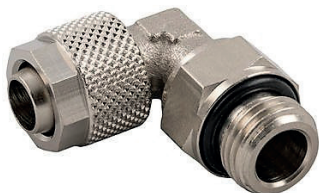

REFERENCE	THREAD	
ME186	BSP 1/8	6 x 4 mm
ME146	BSP 1/4	6 x 4 mm
ME188	BSP 1/8	8 x 6 mm
ME148	BSP 1/4	8 x 6 mm
ME1410	BSP 1/4	10 x 8 mm

**TYPE TP**

**POLYETHYLENE HOSE**



REFERENCES	Ø INSIDE	Ø OUTSIDE	MAX. WORKING PRESSURE		BURSTING PRESSURE	
			BAR	PSI	BAR	PSI
TP 4X6	4	6	11	159	36	522
TP 5.5X8	5.5	8	9	130	29	520
TP 7X10	7	10	9	130	28	406
TP 8X12	8	12	10	145	32	464

**COLOR AVAILABLE: BLUE (B); RED (R); BLACK (BK); YELLOW (Y); GREEN (G)**

**EXAMPLE CODE** TP 7X10B

**TYPE CC**

**CLOSURE TAP**

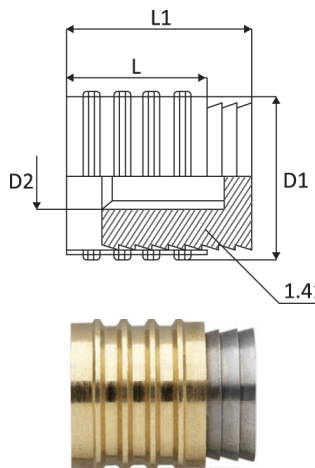

REFERENCE	D1	D2	L	L1
CC6	6	M3	11.5	8
CC7	7	M4	11.5	8
CC8	8	M4	11.5	8
CC10	10	M6	14	10
CC12	12	M6	14	10
CC14	14	M8	16	12
CC15	15	M8	16	12
CC16	16	M8	16	12



## TYPE TP

## CYLINDRICAL SOCKET SCREW PLUGS

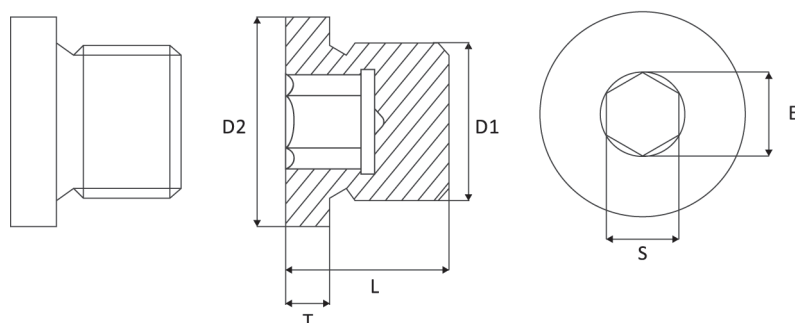

REFERENCE			DIMENSIONS					
STEEL	SSA2	BRASS	THREAD	D2	S	E	L	Tmin.
CM10S	CM10SS	CM10B	M10 x 1	14	5	5,7	11	5
CM12S	CM12SS	CM12B	M12 x 1,5	17	6	6,9	15	7
CM14S	CM14SS	CM14B	M14 x 1,5	19	6	6,9	15	7
CM16S	CM16SS	CM16B	M16 x 1,5	21	8	9,2	15	7,5
CM18S	CM18SS	CM18B	M18 x 1,5	23	8	9,2	16	7,5
CM20S	CM20SS	CM20B	M20 x 1,5	25	10	11,4	18	7,5
CM22S	CM22SS	CM22B	M22 x 1,5	27	10	11,4	18	7,5
CM24S	CM24SS	CM24B	M24 x 1,5	29	12	13,7	18	7,5
CM26S	CM26SS	CM26B	M26 x 1,5	31	12	13,7	20	9
CM27S	CM27SS	CM27B	M27 x 2	32	12	13,7	20	9
CM30x1,5S	CM30x1,5SS	CM30x1,5B	M30 x 1,5	36	17	19,4	20	9
CM30S	CM30SS	CM30B	M30 x 2	36	17	19,4	20	9
CM36x1,5S	CM36x1,5SS	CM36x1,5B	M36 x 1,5	42	19	21,7	21	10,5
CM36S	CM36SS	CM36B	M36 x 2	42	19	21,7	21	10,5
CM38S	CM38SS	CM38B	M38 x 1,5	42	19	21,7	21	10,5
CM42S	CM42SS	CM42B	M42 x 1,5	49	22	25,2	21	10,5
CM45S	CM45SS	CM45B	M45 x 1,5	52	22	25,2	21	10,5
CM48S	CM48SS	CM48B	M48 x 1,5	55	24	27,4	21	10,5
CM52x1,5S	CM52x1,5SS	CM52x1,5B	M52 x 1,5	60	24	27,4	21	10,5
CM52S	CM52SS	CM52B	M52 x 2	60	24	27,4	21	10,5
GAS THREAD								
C18S	C18SS	C18B	G1/8	14	5	5,7	11	5
C14S	C14SS	C14B	G1/4	18	6	6,9	15	7
C38S	C38SS	C38B	G3/8	22	8	9,2	15	7,5
C12S	C12SS	C12B	G1/2	26	10	11,4	18	7,5
C34S	C34SS	C34B	G3/4	32	12	13,7	20	9
C61S	C61SS	C61B	G6 1	39	17	19,4	21	9
C114S	C114SS	C114B	G1 1/4	49	22	25,2	21	10,5
C112S	C112SS	C112B	G1 1/2	55	24	27,4	21	10,5
C134S	C134SS	C134B	G1 3/4	-	-	-	-	-
C2S	C2SS	C2B	G2	68	32	36,6	25	14



## TYPE TP

## CYLINDRICAL SOCKET SCREW PLUGS

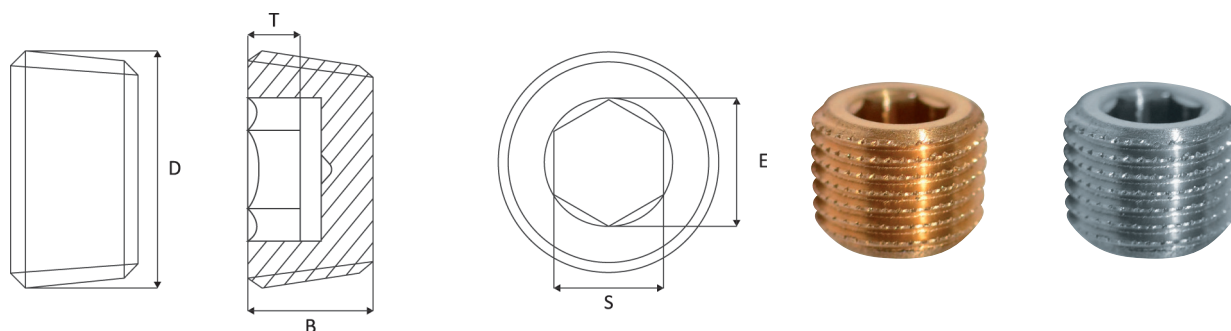

REFERENCE			DIMENSIONS				
STEEL	SSA2	BRASS	THREAD	B	S	E	Tmin.
PM8S	PM8SS	PM8B	M8 x 1	8	4	4,6	4
PM10S	PM10SS	PM10B	M10 x 1	8	5	5,7	4
PM12S	PM12SS	PM12B	M12 x 1,5	10	6	6,9	5
PM14S	PM14SS	PM14B	M14 x 1,5	10	7	8	5
PM16S	PM16SS	PM16B	M16 x 1,5	10	8	9,2	5
PM18S	PM18SS	PM18B	M18 x 1,5	10	8	9,2	5
PM20S	PM20SS	PM20B	M20 x 1,5	10	10	11,4	5
PM22S	PM22SS	PM22B	M22 x 1,5	10	10	11,4	5
PM24S	PM24SS	PM24B	M24 x 1,5	12	12	13,7	6
PM26S	PM26SS	PM26B	M26 x 1,5	12	12	13,7	6
PM27S	PM27SS	PM27B	M27 x 1,5	12	12	13,7	6
PM30x1,5S	PM30x1,5SS	PM30x1,5B	M30 x 1,5	12	17	19,4	6
PM30S	PM30SS	PM30B	M30 x 2	12	17	19,4	6
PM36x1,5S	PM36x1,5SS	PM36x1,5B	M36 x 1,5	15	19	21,7	7,5
PM36S	PM36SS	PM36B	M36 x 2	15	19	21,7	7,5
PM38S	PM38SS	PM38B	M38 x 1,5	15	19	21,7	7,5
PM42S	PM42SS	PM42B	M42 x 1,5	18	22	25,2	11,5
GAS THREAD							
P18S	P18SS	P18B	R 1/8	8	5	5,7	4
P14S	P14SS	P14B	R 1/4	10	7	8	5
P38S	P38SS	P38B	R 3/8	10	8	9,2	5
P12S	P12SS	P12B	R 1/2	10	10	11,4	5
P34S	P34SS	P34B	R 3/4	12	12	13,7	6
P1S	P1SS	P1B	R1	12	17	19,4	6
P114S	P114SS	P114B	R1 1/4	18	22	25,2	11,5
P112S	P112SS	P112B	R1 1/2	20	24	27,4	11,5
P2S	P2SS	P2B	R2	22	32	35,6	17
NPT THREAD							
P116SN	P116SSN	P116BN	1 1/6	8	4	4,6	4
P18SN	P18SSN	P18BN	1/8	8	5	5,7	4
P14SN	P14SSN	P14BN	1/4	10	7	8	5
P38SN	P38SSN	P38BN	3/8	10	8	9,2	5
P12SN	P12SSN	P12BN	1/2	10	10	11,4	5
P34SN	P34SSN	P34BN	3/4	12	12	13,7	6
P1SN	P1SSN	P1BN	1	12	17	19,4	6



## TYPE TP

## HEXAGON SOCKET SCREW PLUGS

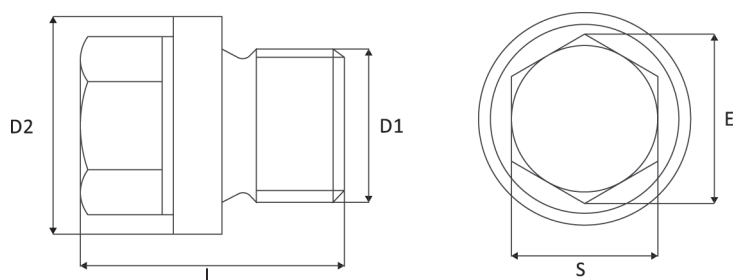

REFERENCE		DIMENSIONS				
STEEL	SSA2	THREAD	D2	S	E	L
HM10S	HM10SS	M10 x 1	14	10	10,89	17
HM12S	HM12SS	M12 x 1,5	17	13	14,2	21
HM14S	HM14SS	M14 x 1,5	19	13	14,2	21
HM16S	HM16SS	M16 x 1,5	21	17	18,72	21
HM18S	HM18SS	M18 x 1,5	23	17	18,72	24
HM20S	HM20SS	M20 x 1,5	25	19	20,88	26
HM22S	HM22SS	M22 x 1,5	27	19	20,88	26
HM24S	HM24SS	M24 x 1,5	29	22	23,91	27
HM26S	HM26SS	M26 x 1,5	31	24	26,17	30
HM27S	HM27SS	M27 x 1,5	32	24	26,17	30
HM30x1,5S	HM30x1,5SS	M30 x 1,5	36	24	26,17	30
HM30S	HM30SS	M30 x 2	36	24	26,17	30
HM36x1,5S	HM36x1,5SS	M36 x 1,5	42	27	29,56	32
HM36S	HM36SS	M36 x 2	42	27	29,56	32
HM38S	HM38SS	M38 x 1,5	44	27	29,56	32
HM42S	HM42SS	M42 x 1,5	49	30	32,95	33
HM45S	HM45SS	M45 x 1,5	52	30	32,95	33
HM48S	HM48SS	M48 x 1,5	55	30	32,95	33
HM52x1,5S	HM52x1,5SS	M52 x 1,5	60	30	32,95	33
HM52S	HM52SS	M52 x 2	60	30	32,95	33
GAS THREAD						
H18S	H18SS	G1/8	14	10	10,89	17
H14S	H14SS	G1/4	18	13	14,2	21
H38S	H38SS	G3/8	22	17	18,72	21
H12S	H12SS	G1/2	26	19	20,88	26
H34S	H34SS	G3/4	32	24	26,17	30
H1S	H1SS	G1	39	27	29,56	32
H114S	H114SS	G1 1/4	49	30	32,95	33
H112S	H112SS	G1 1/2	55	30	32,95	33
H134S	H134SS	G1 3/4	62	36	39,55	40
H2S	H2SS	G2	68	36	39,55	40



**TYPE PFM**

**PLATE FOR FIXING MICROS**

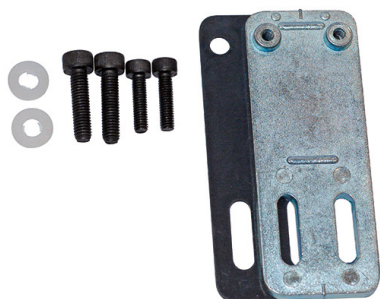

**REFERENCE**

PFM 01

**PLATE FOR FIXING MICROS**

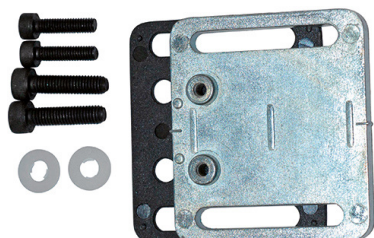

**REFERENCE**

PFM 02

**TYPE PFM**

**PLATE FOR FIXING MICROS**



**REFERENCE**

PFM 03

**TYPE PFM**

**PLATE FOR FIXING MICROS**

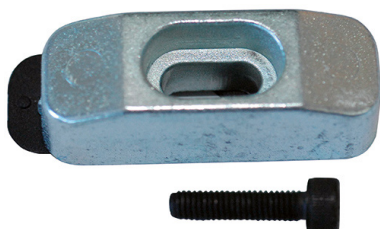

**REFERENCE**

PFM 04